

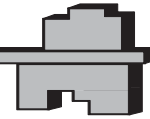

KEY RESIN COMPANY



KEY #467-HS URETHANE TOPCOAT

DESCRIPTION

KEY RESIN #467-HS is a two component, chemical resistant, ultra high solids aliphatic polyurethane coating. **KEY #467-HS** is a low VOC, compliant urethane that meets all federal and state environmental air quality standards. The high gloss or satin finish offers excellent abrasion resistance, chemical and stain resistance. **KEY #467-HS** can be used equally well on vertical or horizontal surfaces. It is ideal for concrete floors and walls in warehouses, storage facilities, aircraft hangars, animal housing, restrooms, vehicle maintenance facilities, and numerous other applications. Available in clear with optional pigment packs, **KEY #467-HS** can be used as a finish coating option for most **KEY FLOORING SYSTEMS**. Optional **HTS** component for use in high traffic/high wear applications.

KEY ADVANTAGES

- Excellent Abrasion Resistance, Optional HTS Additive Available for Additional Resistance
- Excellent Chemical & Stain Resistance
- Suitable for Both Exterior & Interior Applications
- May be Used for Both Horizontal & Vertical Applications
- Compliant to Low VOC Air Regulations, Low Odor

KEY CONSIDERATIONS

- Substrate moisture testing and preparation is required as outlined in Technical Bulletin #1
- Substrate must be free of dirt, waxes, curing agents, and other foreign materials
- Minimum/Maximum Application Temperature: 50°F/90°F
- Minimum/Maximum Relative Humidity: 30%/90%

COMPOSITION

Two, three or four component, catalyzed, chemical resistant, moisture cure aliphatic polyurethane.

APPLICATION

SURFACE PREPARATION

Surface Preparation is the most critical portion of any successful resinous flooring system application. All substrates must be properly prepared as outlined in **KEY RESIN COMPANY'S TECHNICAL BULLETIN #1**. Work must be performed by trained or experienced contractors or maintenance personnel.

INSTALLATION

KEY #467-HS is normally applied using a dip and roll procedure with a short nap mohair roller, followed immediately with thorough cross rolling. **Review detailed installation instructions document prior to use.** Care should be taken to minimize the entrapment of air caused by over-rolling. Apply material within the recommended thickness range. Do not thin material. **KEY #467-HS** must be aggressively sanded prior to application of a second topcoat. **KEY #467-HS** is a moisture cure urethane, relative humidity will significantly affect cure speed. Refer to Installation Instructions document for important additional details.

CLEAN UP

Clean skin with soap and water. Tools and equipment should be cleaned with xylene or lacquer thinner.

COVERAGE

KEY #467-HS Clear will yield 2.9-3.2 mils dry film thickness when spread at 450-500 ft² per gallon. **KEY #467-HS** Pigmented will yield 3.0-3.3 mils dry film thickness when spread at 450-500 ft² per gallon.

COLOR SELECTION

KEY #467-HS is available in Clear (gloss or satin) with optional Urethane Pigment Packs in Key Urethane Standard Colors or custom colors subject to lab approval and minimum quantities. Pigment Packs **MUST** be added only after first thoroughly mixing Part A and Part B.

TECHNICAL DATA

Hardness (ASTM D 3363 Pencil)	2H to 3H
Abrasion Resistance ASTM D 4060 (<i>Taber Abraser 1000 gm. load per wheel</i>)	10-20 mgs./1000 cycles, CS-17 Wheel
Solids Content (by volume)	90% Clear 93% Pigmented
Volatile Organic Content (VOC)	100 g/L Compliant in all U.S. states, except Los Angeles SCAQMD counties
Dry Film Thickness	2.8-2.9 mils @ 500 square feet per gallon application thickness

CURE/DRY TIME (Applied at 450-500 square feet per gallon)

Pot Life	2 hours @ 75°F, 50% RH
Re-Coat (must sand first coat)	8-10 hours @ 75°F, 50% RH
Light Service (foot traffic)	16-24 hours @ 75°F, 50% RH
General Service (vehicle traffic)	72+ hours* @ 75°F, 50% RH *varies by temp and RH
Full Cure & Maximum Resistance to Staining	5-7 days* @ 75°F, 50% RH *varies by temp and RH

AVAILABILITY

KEY RESINS are available throughout the United States, Canada, and a number of other countries. Contact the **KEY REPRESENTATIVE** in your area for details.

MAINTENANCE

After completing the application of **KEY #467-HS**, the installer should provide the owner with maintenance instructions. **KEY #467-HS** is easily cleaned with neutral soaps or detergents. Refer to Technical Bulletins #3 and #3-A for additional information.

TECHNICAL SERVICE

Key Resin Company and **KRC Associates, Inc.** provide services and consultations on material selection, specification, troubleshooting, and other information on the proper repair and protection of concrete surfaces. **Key Sales/Technical Representatives** are available to assist you, telephone (888)943-4532 or visit www.keyresin.com.

WARRANTY

Key Resin Company ("Key") warrants for a period of one (1) year that its products will be free of manufacturing defects and will be in conformity with published specifications when handled, stored, mixed, and applied in accordance with recommendations of **Key**. If any product fails to meet this warranty, the liability of **Key** will be limited to replacement of any non-conforming material if notice of such non-conformity is given to **Key** within (1) one year of delivery of materials. **Key** may in its discretion refund the price received by **Key** in lieu of replacing the material. No customer, distributor, or representative of **Key** is authorized to change or modify the published specifications of this warranty in any way. No one is authorized to make oral warranties on behalf of **Key**. In order to obtain replacement or refund the customer must provide written notice containing full details of the non-conformity. **Key** reserves the right to inspect the non-conforming material prior to replacement. EXCEPT FOR THE EXPRESSED WARRANTY STATED ABOVE, THERE ARE NO OTHER WARRANTIES, EXPRESSED OR IMPLIED, INCLUDING WITHOUT LIMITATION, ANY IMPLIED WARRANTY OF MERCHANTABILITY OR FITNESS FOR PURPOSE. **KEY'S OBLIGATION SHALL NOT EXTEND BEYOND THE OBLIGATIONS EXPRESSLY UNDERTAKEN ABOVE AND KEY SHALL HAVE NO LIABILITY OR RESPONSIBILITY TO THE PURCHASER OR ANY THIRD PARTY FOR ANY LOSS, COST, EXPENSE, DAMAGE OR LIABILITY, WHETHER DIRECT OR INDIRECT, OR FOR INCIDENTAL OR CONSEQUENTIAL DAMAGES.**

CHEMICAL RESISTANCE

REAGENT	RATING
Acetic Acid-5%	L
Acetone	L
Betadine	R
Beer	R
Bleach	L
Brake Fluid	R
Citric Acid-30%	R
Citric Acid-40%	L
Crude Oil	R
Diesel Fuel	R
Ethylene Glycol	R
Fatty Acids	L
Gasoline	R
Hydrochloric Acid-15%	R
Iodine	R
Lactic Acid-15%	R
Methyl Ethyl Ketone	L
Nitric Acid-10%	R
Orange Juice	R
Peroxide-35%	R
Phosphoric Acid-85%	L
Skydrol	R
Sodium Hydroxide-50%	R
Sulfuric Acid-20%	R
Toluene	R
Urea	R
Vinegar	L
Xylene	R

R-Recommended for continuous service.

L-Limited Recommendation, occasional spills with frequent cleaning.

*-May cause slight stain or discoloration.